

## ECOLED III

VOLL LED HECKLEUCHE MIT  
GLOWING BODY TECHNOLOGIE

FULL LED REAR LAMP WITH  
GLOWING BODY TECHNOLOGY



[aspoeck.com](http://aspoeck.com)



# PRODUCT INFO

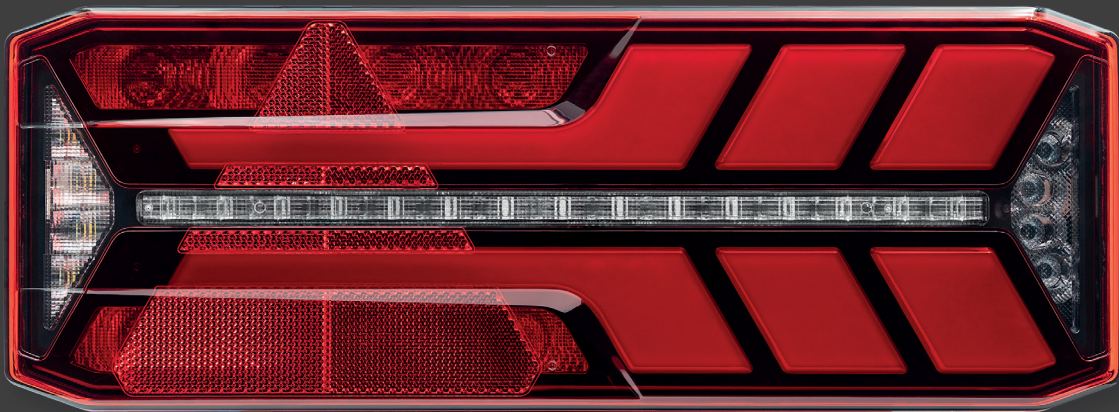



## ECOLED III

VOLL LED HECKLEUCHE MIT GLOWING BODY TECHNOLOGIE

FULL LED REAR LAMP WITH GLOWING BODY TECHNOLOGY

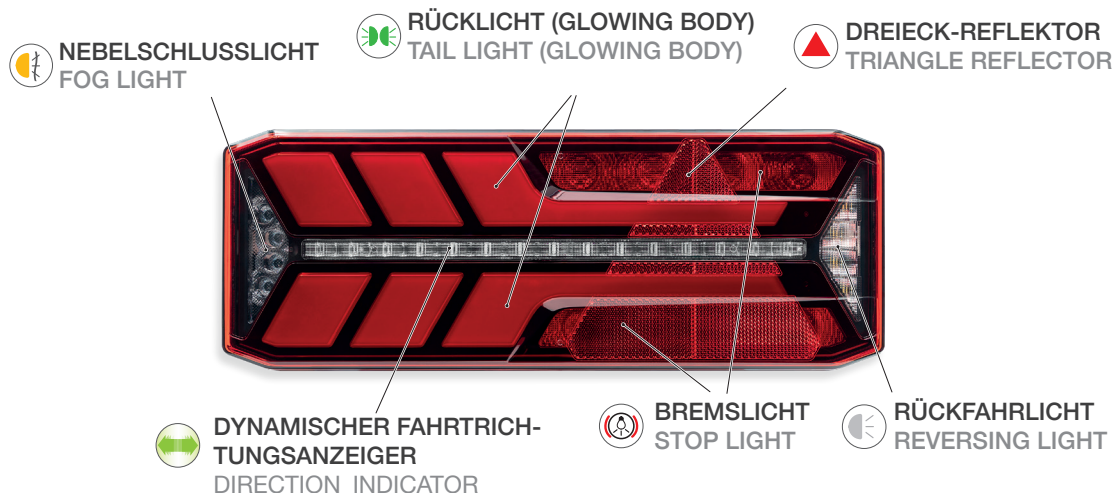

DYNAMISCHER BLINKER PROGRESSIVE DIRECTION INDICATOR	RÜCKLICHT TAIL LIGHT	BREMSLICHT STOP LIGHT	NEBELSCHLUSSLICHT FOG LIGHT
RÜCKFAHRLICHT REVERSE LIGHT	DREIECKRÜCKSTRAHLER TRIANGLE REFLECTOR		

### FEATURES



#### INNOVATIVE GLOWING BODY TECHNOLOGIE ALS STANDLICHT

INNOVATIVE GLOWING BODY TECHNOLOGY AS TAIL LIGHT

#### ERHÖHTE SICHTBARKEIT DURCH GROSSDIMENSIONIERTE LEUCHTFLÄCHE

INCREASED VISIBILITY DUE TO LARGE LUMINOUS AREA

#### DYNAMISCHER FAHRTRICHTUNGSANZEIGER

PROGRESSIVE DIRECTION INDICATOR

#### ISO-IMPULS 13207-1 ALS STANDARD (BEI 24 V)

ISO PULSE 13207-1 AS STANDARD (AT 24 V)

#### CHEMIKALIEN- UND KRATZBESTÄNDIGE LICHTSCHEIBE

CHEMICAL AND SCRATCH RESISTANT LENS

#### SMCG INKLUDIERT (BEI VERSION MIT 2 POL. ABGÄNGEN) GEMÄSS DER ECE 48. REV. 6

SMCG INCLUDED FOR VERSION WITH 2 PIN OUTPUTS) ACCORDING TO ECE 48, REV. 6

#### KREUZSCHALTUNG DES STANDLICHTS

CROSS WIRING OF THE TAIL LIGHT

#### LED UMRISSELEUCHE WIRD MIT EINEM HALTEWINKEL (MIT SOLLBRUCHSTELLE) MONTIERT

LED END OUTLINE MARKER IS MOUNTED WITH A MOUNTING BRACKET, WHICH HAS A PREDETERMINED BREAKING POINT

#### OPTIONAL MIT 4 X 2 POL. ANSCHLÜSSE AUF DER LEUCHTEN-RÜCKSEITE

OPTIONAL WITH 4 X 2-PIN CONNECTIONS ON THE REAR OF THE LAMP

#### HOHE IP-KLASSE IP6K9K

HIGH IP-CLASS IP6K9K



TECHNISCHE DATEN TECHNICAL FACTS																
SPANNUNGSBEREICH: VOLTAGE RANGE:		18 V - 32 V														
NENNSPANNUNG: NOMINAL VOLTAGE:		24 V														
LEISTUNGS-AUFNAHME BEI NENN- SPANNUNG POWER CONSUMPTION NOMINAL VOLTAGE: W (WATT)	BLINKER: DIRECTION INDICATOR:	0.3 W / 8.3 W (28 V)														
	BREMSLICHT: STOP LIGHT:	0.14 W / 3.8 W (28 V)														
	RÜCKFAHRLICHT: REVERSE LIGHT:	0.01 W / 2.7 W (28 V)														
	STANDLICHT RECHTS: TAIL LIGHT RIGHT	0.09 W / 3.5 W (28 V)														
	STANDLICHT LINKS: TAIL LIGHT LEFT:	0.13 W / 3.6 W (28 V)														
	NEBELSCHLUSSLICHT: FOG LIGHT:	0.14 W / 4.0 W (28 V)														
VERPOLSCHUTZ: REVERSE POLARITY PROTECTION:		JA YES														
MATERIAL:	GEHÄUSE: HOUSING:	ABS														
	LICHTSCHEIBE: LENS:	PMMA														
TEMPERATURBEREICH: TEMPERATURE RANGE:		-40°C~ +60°C														
SCHUTZART DER LEUCHE: PROTECTION CLASSIFICATION OF THE LAMP:		IP 6K9K														
EMV-ZULASSUNG: EMC APPROVAL:		10R 06														
TYPGENEHMIGUNG: TYPE APPROVAL:		<table border="1"> <tr> <td>R1</td> <td>S1</td> <td>2a</td> <td>AR</td> <td>F1</td> <td>148R00</td> <td rowspan="2">E9</td> <td rowspan="2">1928</td> </tr> <tr> <td colspan="5">IIIA</td> <td>150R00</td> </tr> </table>	R1	S1	2a	AR	F1	148R00	E9	1928	IIIA					150R00
R1	S1	2a	AR	F1	148R00	E9	1928									
IIIA					150R00											

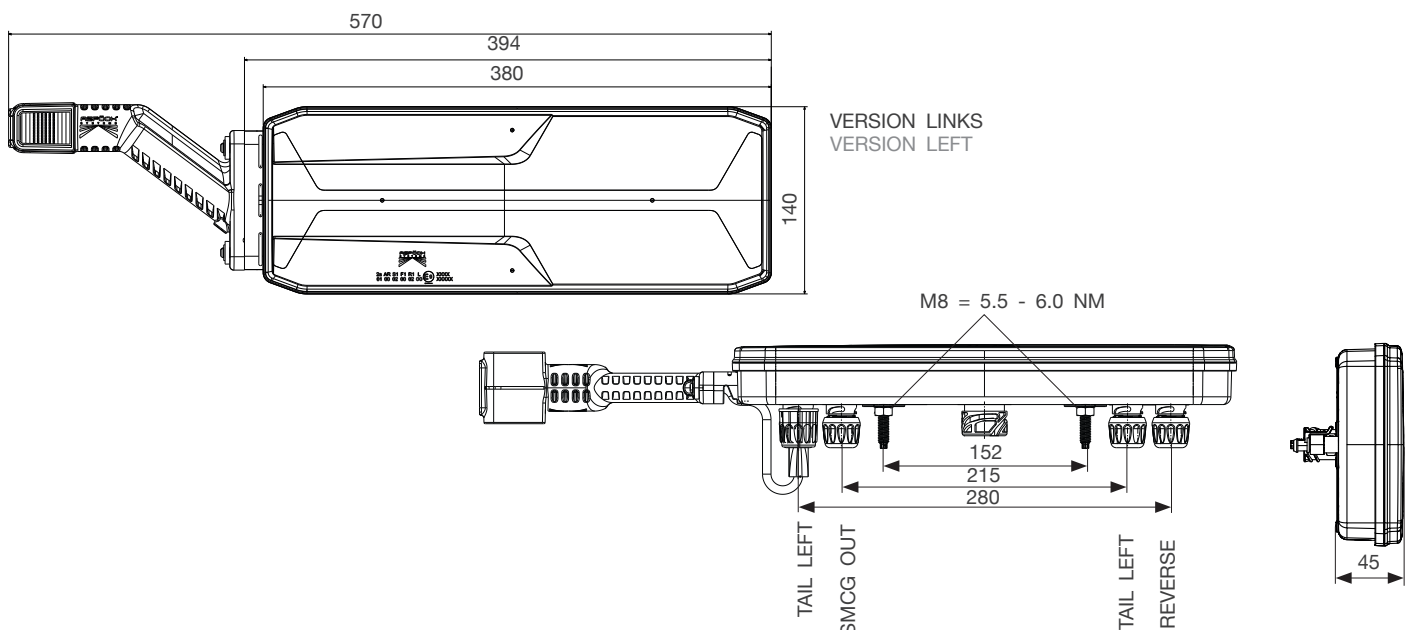

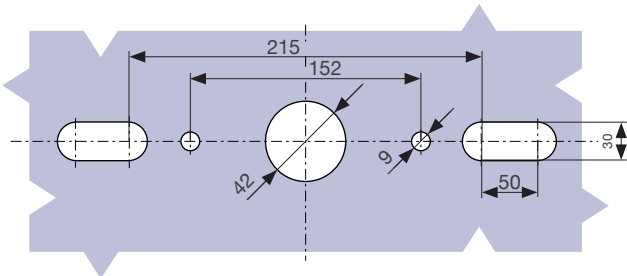

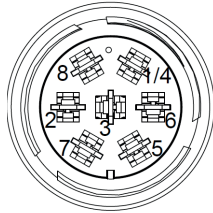
ANSCHLUSS 7 POL. ASS2.1 CONNECTOR 7 PIN ASS2.1		
BLINKER   DIRECTION INDICATOR:	1/4	
NEBELSCHLUSSLICHT   FOG LIGHT:	2	
MASSE   GROUND:	3	
RÜCKLICHT RECHTS   TAIL LIGHT RIGHT:	5	
BREMSE   STOP LIGHT:	6	
RÜCKLICHT LINKS   TAIL LIGHT LEFT:	7	
RÜCKFAHRLICHT   REVERSE LIGHT:	8	

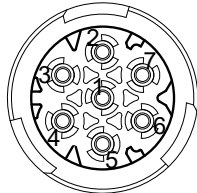
ANSCHLUSS 7 POL. AMP CONNECTOR 7 PIN AMP		
MASSE   GROUND:	1	
RÜCKLICHT LINKS   TAIL LIGHT LEFT:	2	
RÜCKFAHRLICHT   REVERSE LIGHT:	3	
BLINKER   DIRECTION INDICATOR:	4	
BREMSE   STOP LIGHT:	5	
NEBELSCHLUSSLICHT   FOG LIGHT:	6	
RÜCKLICHT RECHTS   TAIL LIGHT RIGHT:	7	

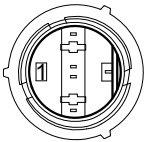
ANSCHLUSS 2 POL. ASS2 CONNECTOR 2 PIN ASS2		
MASSE   GROUND:	1	
VDC+	2	

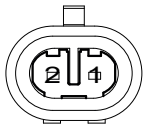
ANSCHLUSS 2 POL. SUPERSEAL CONNECTOR 2 PIN SUPERSEAL		
MASSE   GROUND:	1	
VDC+	2	

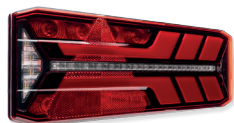

BEST. NR PART NO		BEST. NR AM PART NO AM	←	→				ZUSATZ ADD ON	ANSCHLUSS CONNECTOR
25-4122-017	1/9	25-4122-011		●	LED	24V			7 pol. ASS2 7 pin ASS2
25-4122-027	1/9	25-4122-021		●	LED	24V			7 pol. ASS2 7 pin ASS2
25-4122-037	1/7	25-4122-031		●	LED	24V	LED		7 pol. ASS2 7 pin ASS2
25-4122-047	1/9	25-4122-041		●	LED	24V			7 pol. AMP 7 pin AMP
25-4122-057	1/9	25-4122-051		●	LED	24V			7 pol. AMP 7 pin AMP
25-4122-067	1/7	25-4122-061		●	LED	24V	LED		7 pol. AMP 7 pin AMP
25-4123-017	1/9	25-4123-011	●		LED	24V			7 pol. ASS2 7 pin ASS2
25-4123-027	1/9	25-4123-021	●		LED	24V			7 pol. ASS2 7 pin ASS2
25-4123-037	1/7	25-4123-031	●		LED	24V	LED		7 pol. ASS2 7 pin ASS2
25-4123-047	1/9	25-4123-041	●		LED	24V			7 pol. AMP 7 pin AMP
25-4123-057	1/9	25-4123-051	●		LED	24V			7 pol. AMP 7 pin AMP
25-4123-067	1/7	25-4123-061	●		LED	24V	LED		7 pol. AMP 7 pin AMP

## ZUBEHÖR SPARE PARTS

BEST. NR AM PART NO AM		BESCHREIBUNG DESCRIPTION
31-3103-204	1/-	Umrissarm Superpoint IV 2 pol. ASS2 links, inklusive Haltewinkel + Schrauben end outline marker Superpoint IV 2 pin ASS2 left, inclusive bracket + screws
31-3102-204	1/-	Umrissarm Superpoint IV 2 pol. ASS2 rechts, inklusive Haltewinkel + Schrauben end outline marker Superpoint IV 2 pin ASS2 right, inclusive bracket + screws
31-3103-214	1/-	Umrissarm Superpoint IV AMP 2 pol. supers. links, inklusive Haltewinkel + Schrauben end outline marker Superpoint IV AMP 2 pin supers. left, inclusive bracket + screws
31-3102-214	1/-	Umrissarm Superpoint IV AMP 2 pol. supers. rechts, inklusive Haltewinkel + Schrauben end outline marker Superpoint IV AMP 2 pin right. left, inclusive bracket + screws
31-5300-204	1/-	Haltewinkel für Umrissarm Superpoint IV + Schrauben mounting bracket for end outline marker Superpoint IV + screws

product information\_Ecoled\_III\_V2 | 2024-07  
Misprints, technical changes and illustrations are subject to change.  
© Aspöck Systems GmbH

Non-compliance with the information given (e.g. temperature) results in the exclusion of warranty/liability. For details, see the mounting instructions/TSD [www.aspoeck.com](http://www.aspoeck.com).